

**BIG BIKE PARTS®**

Copyright© 2021 by Big Bike Parts, Inc. No part of this instruction sheet may be reproduced without the written permission of Big Bike Parts, Inc.

**INSTALLATION INSTRUCTIONS**

PART NO. 41-209, 41-209G

PASSENGER ARMREST

FITMENT:

CAN-AM RT LTD 2020+ / F3 LTD 2017+

TOOLS NEEDED:	5/16" DRILL BIT	DRILL	5MM ALLEN WRENCH	13MM WRENCH	6MM ALLEN WRENCH
	2MM ALLEN WRENCH	PHILLIP SCREWDRIVER			

**PLEASE READ THROUGH AND UNDERSTAND THESE INSTRUCTIONS BEFORE BEGINNING. USE REMOVABLE THREAD LOCK ON ALL FASTENERS.**

**ESTIMATED INSTALLATION TIME: 60 TO 90 MIN.**

**INSTALLATION:**

1. OPEN THE TRUNK LID AND TURN THE QUICK RELEASE COUNTERCLOCKWISE TO THE UNLOCK POSITION (**FIG. 1**).
2. FROM THE REAR OF THE BIKE, SLIGHTLY LIFT UP ON THE REAR OF THE TRUNK AND PUSH IN ON THE SAFETY RELEASE (**FIG. 2**) WHILE LIFTING THE TRUNK SLIGHTLY.
3. CAREFULLY PULL THE TRUNK BACK TOWARDS THE REAR OF THE BIKE TO RELEASE IT FROM THE FRONT MOUNTS TO ALLOW YOU TO LIFT THE REAR OF THE TRUNK UP HIGHER (**FIG. 3**).
4. WHILE HOLDING UP ON THE REAR OF THE TRUNK, DISCONNECT THE TRUNK WIRE HARNESS (**FIG. 3**).
5. CAREFULLY LIFT THE TRUNK OFF OF THE BIKE AND PLACE ON A CLEAN SURFACE.
6. ON THE LEFT SIDE OF THE TRUNK, PLACE A PIECE OF MASKING TAPE ON THE OUTSIDE OF THE TRUNK ACCORDING TO **FIG. 4**.
7. REMOVE THE LEFT AND RIGHT BASE MOUNT FROM THE PACKAGING (USE **FIG. 5** TO DETERMINE THE LEFT AND RIGHT BASE MOUNT). SET THE RIGHT BASE MOUNT ASIDE FOR NOW.
8. HOLD THE LEFT BASE MOUNT IN PLACE ON THE LEFT SIDE OF THE TRUNK (**FIG. 5**) AND MARK THE TWO HOLES.
9. REMOVE THE LEFT BASE MOUNT FROM THE TRUNK AND SET ASIDE FOR NOW.
10. CAREFULLY MEASURE AND MARK A THIRD HOLE ACCORDING TO **FIG. 7**. (BE SURE THAT THE THREE HOLE PATTERN MATCHES THE BASE MOUNT BRACKET BEFORE DRILLING)
11. CAREFULLY DRILL A 5/16" HOLE CENTERED ON EACH MARK FROM STEP 8 AND 10. (BBP RECOMMENDS USING A STEP DRILL BIT OR BRAD POINT DRILL BIT WHEN DRILLING PLASTIC PARTS).
12. WITH THE LEFT BASE MOUNT HELD IN PLACE, INSTALL THE THREE M8-1.25 X 25MM LONG SCREWS THROUGH THE THREE HOLES YOU DRILLED IN STEP 11 (**FIG. 8**).
13. ON THE INSIDE OF THE TRUNK, INSTALL THE INNER BRACKET AND THREE M8-1.25 NYLOCK NUTS (**FIG. 9**).
14. USE **FIG. 10** TO DETERMINE THE LEFT AND RIGHT ARMS.
15. INSTALL THE REMAINING LEFT SIDE ARMREST COMPONENTS ACCORDING TO **FIG. 11**. (DO NOT TIGHTEN THE SET SCREW OR JAM NUT) **NOTE: THE SET SCREW IS OPTIONAL.**
16. TO ADJUST EACH ARM REST, WITH THE SET SCREW AND JAM NUT LOOSE, USE A 6MM ALLEN WRENCH TO TIGHTEN THE PIVOT BOLT (SEEN IN **FIG. 11**). ONLY TIGHTEN ENOUGH TO HOLD ARMREST IN PLACE WHILE STILL ALLOWING ARM REST TO PIVOT AS NEEDED. (DO NOT TURN PIVOT BOLT IF SET SCREW OR JAM NUT ARE TIGHT)
17. USE THE 6MM ALLEN WRENCH TO HOLD THE PIVOT BOLT FROM MOVING AND TIGHTEN THE SET SCREW AND JAM NUT (SEEN IN **FIG. 11**).
18. INSTALL THE CAPS WHEN ARM REST ARE AS DESIRED (SEEN IN **FIG. 11**).
19. REPEAT STEPS 8 THROUGH 18 ON THE RIGHT SIDE OF THE TRUNK.
20. REPEAT STEPS 1 THROUGH 7 IN REVERSE ORDER TO FINISH ASSEMBLING BIKE.

**NOTICE**

IGNORING THE CONTENTS OF THESE INSTRUCTIONS MAY AFFECT THE PRODUCT PERFORMANCE AND FUNCTIONALITY. NOT FOLLOWING THESE INSTRUCTIONS MAY CAUSE DAMAGE TO THE PRODUCT OR THE VEHICLE TO WHICH IT IS BEING ATTACHED.

**WARNING**

THIS PRODUCT WAS DESIGNED TO BE USED AS A PASSENGER ARMREST ONLY. PASSENGER ARMRESTS ARE NOT SAFETY RESTRAINING DEVICES. DO NOT USE THIS PRODUCT TO ASSIST IN MOUNTING OR DISMOUNTING THE MOTORCYCLE. DO NOT APPLY FULL BODY WEIGHT TO THE ARMREST TO ADJUST SEATING POSITION.



STEP DRILL

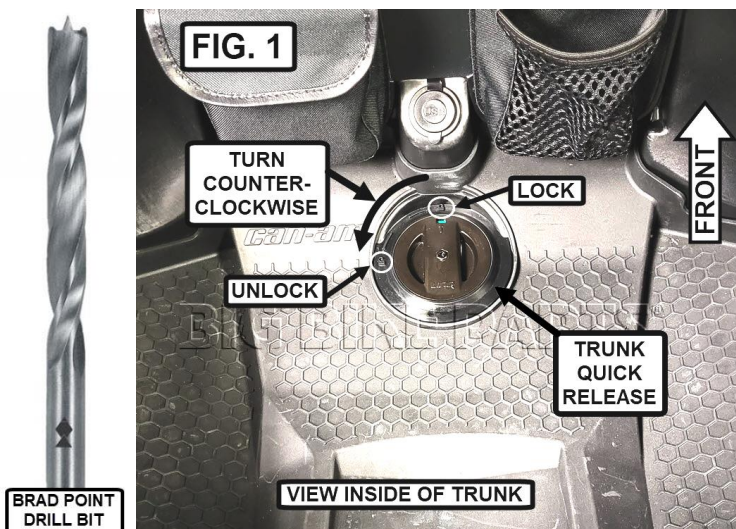

BRAD POINT DRILL BIT

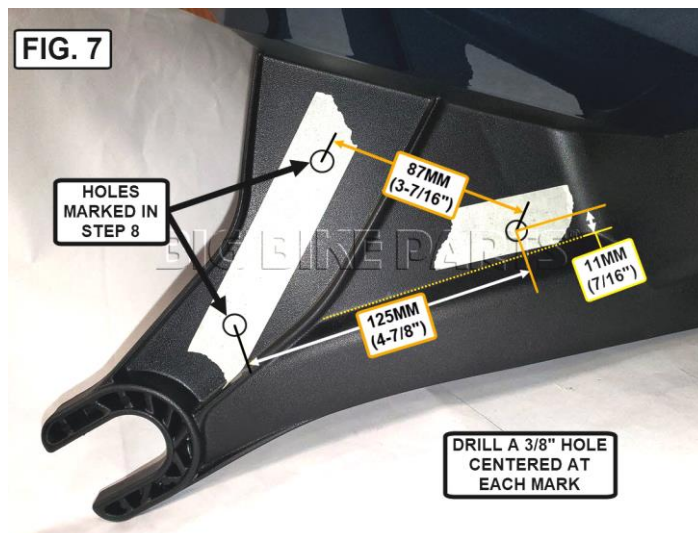
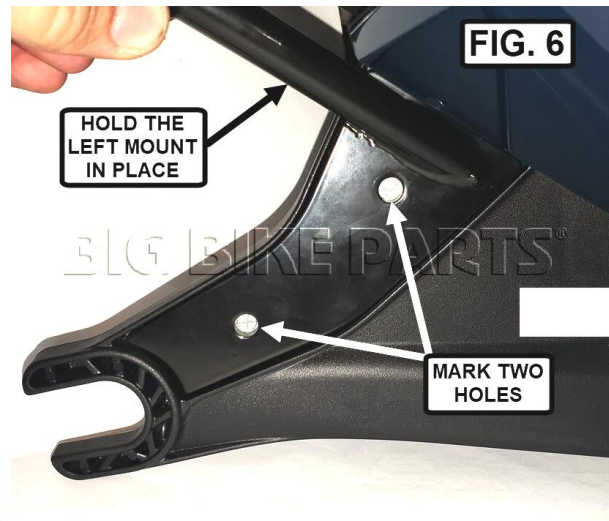
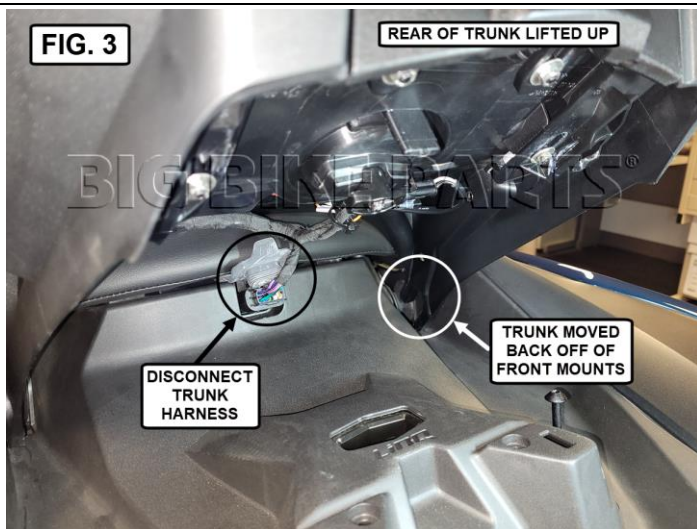



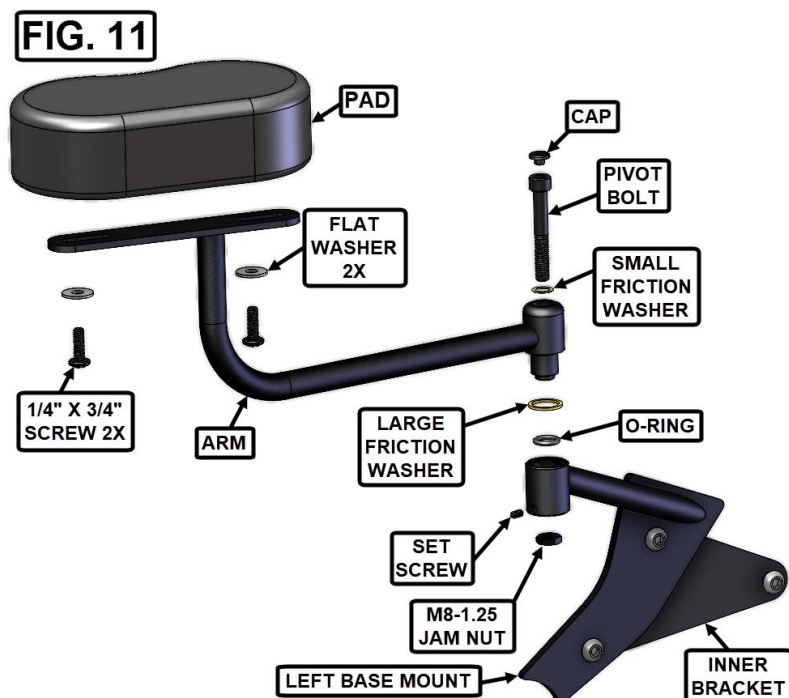
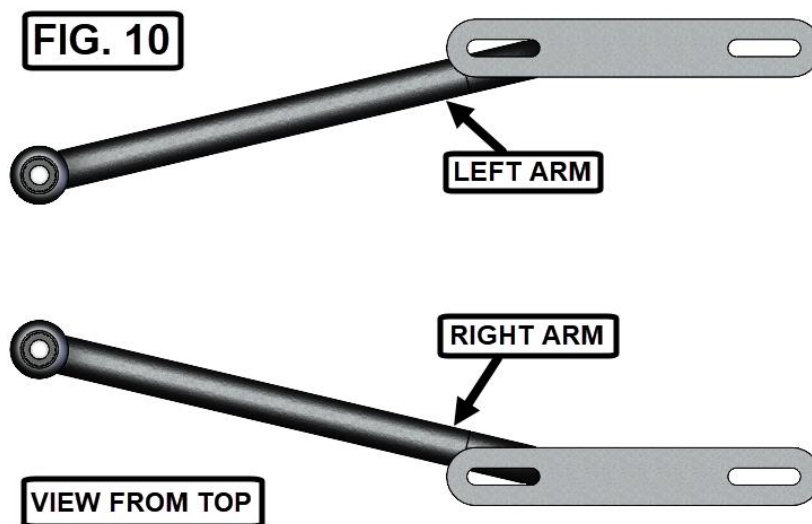
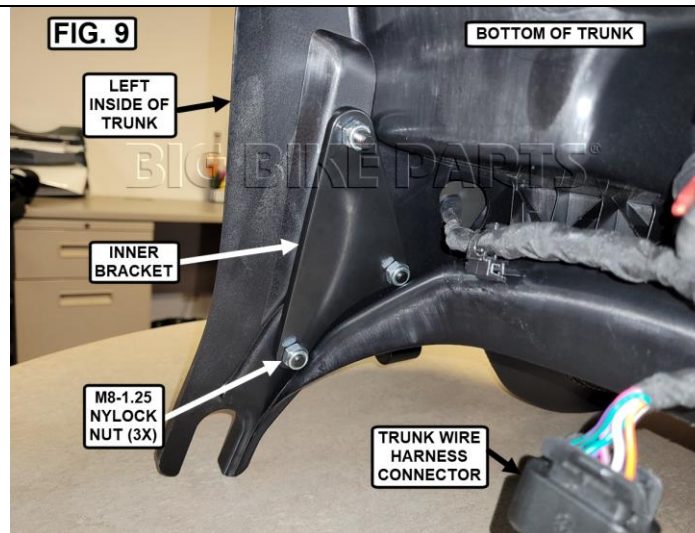

SCAN QR CODE TO WATCH FULL VIDEO ON HOW  
TO ADJUST YOUR ARMREST!