

**SHOW CHROME®**

Copyright© 2023 by Big Bike Parts, Inc. No part of this instruction sheet may be reproduced without the written permission of Big Bike Parts, Inc.

**INSTALLATION INSTRUCTIONS**

PART NO.:

DESCRIPTION:

41-200,  
41-200GQUICK DETACH BACKREST,  
PLATINUM RT GRANDE BACKREST**ESTIMATED INSTALLATION TIME: 20 TO 30 MIN**

FITMENT:

CAN-AM SPYDER RT/ RT LTD 2020+

TOOLS NEEDED:	REMOVABLE THREAD LOCK	5MM ALLEN WRENCH	13MM WRENCH	4MM ALLEN WRENCH	3/16" ALLEN WRENCH
		7/16" ALLEN WRENCH	1/8" ALLEN WRENCH		
INCLUDED:	Backrest Pouch	Backrest Pad Assembly	Riser Mount Assembly	Bike Mount	M8 x 12mm Bolt (x2)
	3/8 X 1-1/2 Fender Washer	M8 x 16mm Bolt	M8 Lock Washer	1/4-20 x 2 3/4" Socket Head Bolt	1/4 – 20 Nylok Nut

**PLEASE READ THROUGH AND UNDERSTAND THESE INSTRUCTIONS BEFORE BEGINNING. \*USE REMOVABLE THREAD LOCK ON ALL FASTENERS\*****INSTALLATION:**

1. WHILE PUSHING DOWN ON THE KEY, TURN IT CLOCKWISE TO RELEASE THE DRIVER SEAT. LIFT UP ON THE FRONT TO OPEN IT (FIG. 1).
2. PRESS THE TWO TABS SECURING THE FRONT OF THE PASSENGER SEAT AND LIFT UP SLIGHTLY TO RELEASE (FIG. 2). (LOCATED AT THE FRONT BOTTOM OF THE PASSENGER SEAT UNDER THE DRIVER SEAT)
3. CLOSE THE DRIVER SEAT TO ALLOW YOU TO LIFT THE FRONT OF THE PASSENGER SEAT UP PAST THE DRIVER SEAT AND SLIDE IT FORWARD TO REMOVE IT.
4. DISCONNECT THE PASSENGER SEAT WIRE HARNESS (FIG. 3).
5. REMOVE THE BIKE MOUNT, THE RISER, AND TWO M8 X 12MM LONG BOLTS FROM THE SMART MOUNT BACKREST KIT. SEE FIG. 4.
6. USING FIG. 4, INSTALL THE TWO M8 X 12MM BOLTS IN THE BIKE MOUNT. (USE REMOVABLE THREAD LOCK ON END OF THREADS)
7. USE THE RISER AS SHOWN IN FIG. 4 TO SET THE HEIGHT OF THE TWO BOLTS. SET THEM SO THAT THE HEAD OF THE SCREW IS AS CLOSE AS POSSIBLE TO THE RISER (SCREWED IN AS FAR AS POSSIBLE TO HOLD THE RISER IN PLACE) BUT THE RISER WILL STILL SLIDE OFF OF THE SCREWS. REMOVE THE RISER FOR NOW.
8. REMOVE THE TWO SCREWS SECURING THE FRONT OF THE PASSENGER SEAT TRAY, SHOWN IN FIG. 5.
9. WHILE LIFTING THE FRONT OF THE PASSENGER SEAT TRAY (FIG. 5), SLIDE THE BIKE MOUNT THROUGH THE BACKREST OPENING IN THE RT AS SHOWN IN FIG. 5. (NOTE: THERE IS A SQUARE FRAME TUBE UNDER THE BACKREST HOLE. BE SURE TO SLIDE MOUNT BETWEEN FRAME TUBE AND PASSENGER SEAT TRAY)
10. INSTALL THE LARGE FENDER WASHER AND LOCK WASHER ON THE M8 X 16MM BOLT AND INSTALL IT THROUGH THE ROUND HOLE AND INTO THE THREADED HOLE IN THE BIKE MOUNT. TIGHTEN WITH AN M5 ALLEN WRENCH (FIG. 5).
11. TIGHTEN THE TWO SCREWS FROM STEP 8.
12. REINSTALL THE PASSENGER SEAT BY REVERSING STEPS 1-4.
13. ASSEMBLE THE BACKREST PAD TO THE RISER AS SHOWN IN FIG. 7.
14. INSTALL THE BACKREST ASSEMBLY ON THE RT BY SLIDING THE RISER THROUGH THE OPENING IN THE PASSENGER SEAT IN FRONT OF THE BIKE MOUNT AND ONTO THE BOLTS AS YOU DID WHEN SETTING THE BOLT HEIGHT IN STEPS 6 AND 7.
15. USE THE SLOTS IN THE ADJUSTMENT PLATE AND THE HOLES IN THE TOP BRACKET TO SET THE BACKREST TO YOUR DESIRED POSITION. SNAP THE POUCH TO THE BACK OF THE BACKREST PAD.

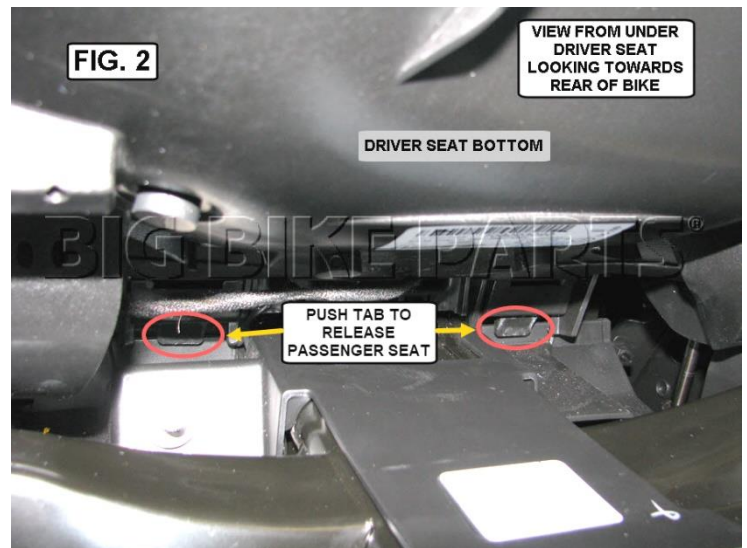
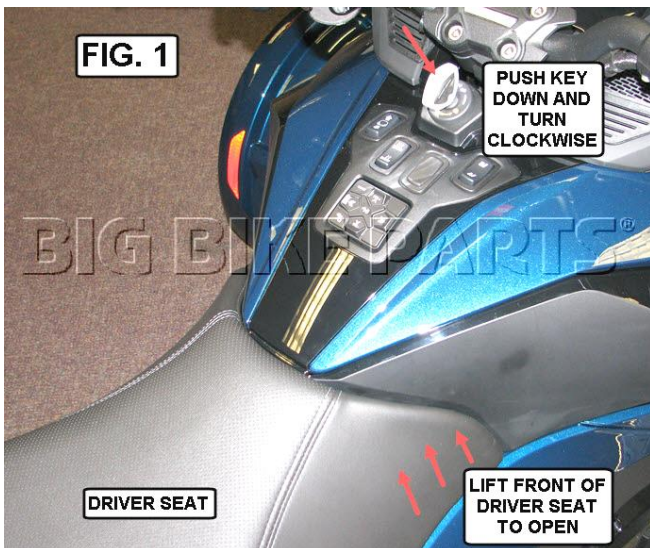

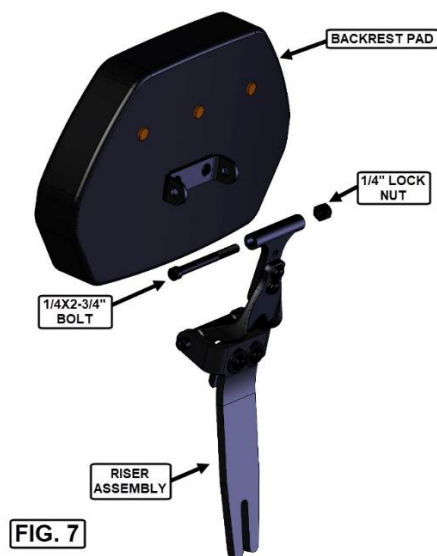
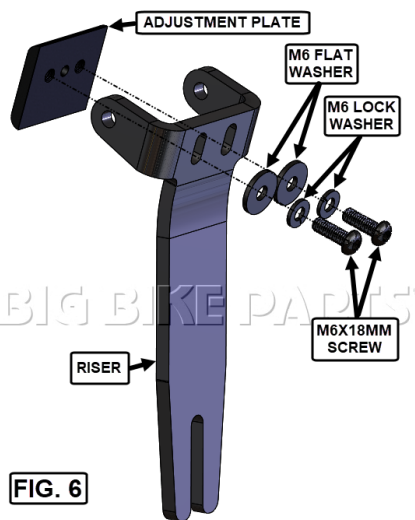
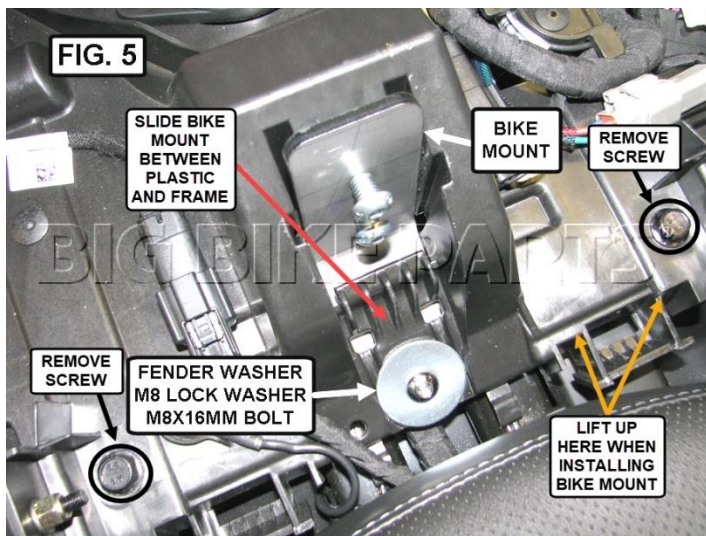
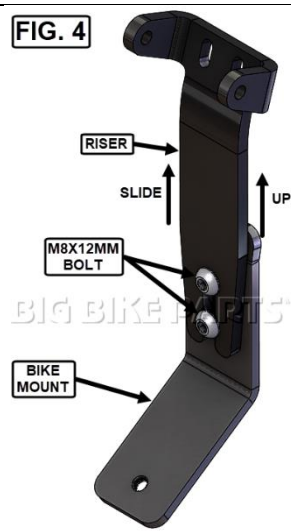
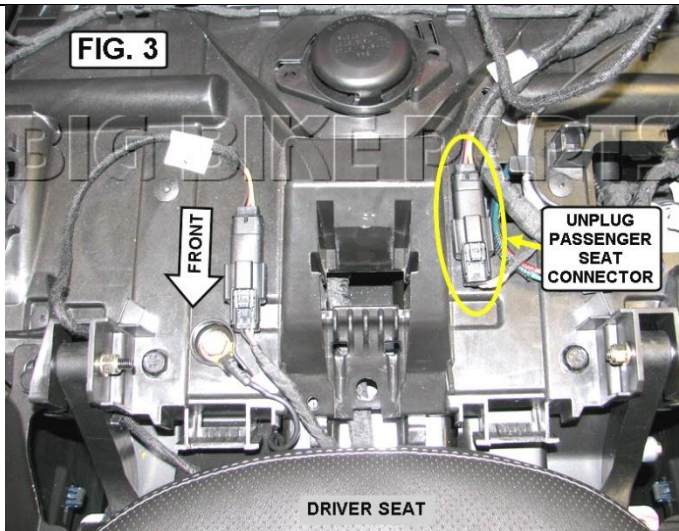

**NOTICE**  
 THIS SET CONTAINS EXTRA HARDWARE ITEMS THAT WILL NOT BE USED FOR THIS INSTALLATION

**WARNING**  
 THREADLOCK CAUSES PLASTICS TO CRACK, BREAK OR BECOME BRITTLE. WHEN USING THREADLOCK TO INSTALL HARDWARE WITH PLASTIC COMPONENTS, ONLY APPLY TO METAL COMPONENTS. IT IS CRITICAL THAT ANY EXCESS THREADLOCKER OR SPILLAGE IS CLEANED COMPLETELY FROM PLASTIC COMPONENTS IMMEDIATELY BEFORE DRYING. A DAMP TOWEL OR RAG IS THE BEST WAY TO ACHIEVE THIS. IF EXCESS THREADLOCKER IS NOT CLEANED UP RIGHT AWAY, IT COULD LEAD TO DAMAGED PRODUCTS AND VOID WARRANTY.

**NOTICE**  
 IGNORING THE CONTENTS OF THESE INSTRUCTIONS MAY AFFECT THE PRODUCT PERFORMANCE AND FUNCTIONALITY. NOT FOLLOWING THESE INSTRUCTION MAY CAUSE DAMAGE TO THE PRODUCT OR THE VEHICLE TO WHICH IT IS BEING ATTACHED.