

INSTALLATION INSTRUCTIONS

TECH-CONNECT DEVICE HOLDER

1693

THANK YOU FOR CHOOSING KURYAKYN!

Protect yourself and others from possible injury and property damage or loss. Pay close attention to all instructions, warnings, cautions, and notices regarding the installation, use, and care of this product.

WARNING THIS INDICATION ALERTS YOU TO THE FACT THAT IGNORING THE CONTENTS DESCRIBED HEREIN CAN RESULT IN POTENTIAL DEATH OR SERIOUS INJURY.

CAUTION THIS INDICATION ALERTS YOU TO THE FACT THAT IGNORING THE CONTENTS DESCRIBED HEREIN CAN RESULT IN MINOR OR MODERATE POTENTIAL INJURY.

NOTICE THIS INDICATION ALERTS YOU TO THE FACT THAT IGNORING THE CONTENTS DESCRIBED HEREIN MAY NEGATIVELY AFFECT PRODUCT PERFORMANCE AND FUNCTIONALITY OR DAMAGE THE PRODUCT ITSELF OR THE PRODUCT TO WHICH IT IS BEING ATTACHED.

ENSURE THAT THE FOLLOWING PARTS HAVE BEEN INCLUDED IN THE KIT:

- | | | | |
|---|----------------------------|---|---------------------------------------|
| 1 | Tech-Connect Device Holder | 1 | Hardware Kit Containing: |
| 1 | Installation Instructions | 2 | #8-32 X 5/8" Phillips Head Pan Screws |
| | | 2 | #8 SAE Flat Washers |
| | | 4 | 6" Black Nylon Cable Ties |
| | | 1 | Thin Foam Pad |

YOU WILL ALSO NEED:

Small Phillips Screwdriver

NOTICE THESE INSTALLATION INSTRUCTIONS CONTAIN IMPORTANT INFORMATION. ENSURE THE END USER RECEIVES THIS COPY AND IS AWARE OF ITS IMPORTANCE FOR FUTURE USE.

STEP 1 Read and understand all steps in the instructions before starting the installation. Park the motorcycle on a hard, level surface and turn off the ignition.

NOTE: The Tech-Connect Mobile Device Holder requires the separate purchase and installation of an accessory mount.

NOTE: For devices measuring 1-5/8" to 3-5/8" wide.

CAUTION ENSURE THAT THE INSTALLATION OF THIS PRODUCT DOES NOT INTERFERE WITH THE PROPER OPERATION OF THE MOTORCYCLE BEFORE RIDING.

NOTICE IT IS THE INSTALLER'S RESPONSIBILITY TO ENSURE THAT THERE IS ADEQUATE CLEARANCE BETWEEN THE TECH-CONNECT AND ANY PAINTED SURFACES. KURYAKYN IS NOT RESPONSIBLE FOR ANY DAMAGE DUE TO INADEQUATE CLEARANCE.

BE AWARE OF ANY CABLES/WIRES THAT COULD POTENTIALLY BE PINCHED OR CRUSHED WHILE USING THIS PRODUCT.

STEP 2 The Tech-Connect Device Holder can be mounted to Kuryakyn Accessory mounts with ease. PIC 1 It may fit other accessory mounts with two mounting holes 1-15/16" apart for mounting with #8-32 screws. Works well with Ram Mounts.

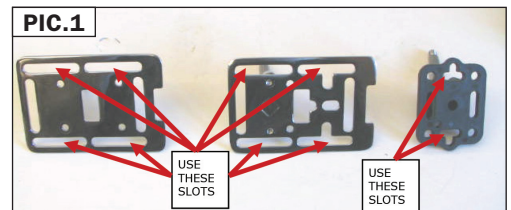

KURYAKYN.COM

866 277 9598 | INFO@KURYAKYN.COM
454 COUNTY ROAD VV SOMERSET, WI 54025



INSTALLATION INSTRUCTIONS

TECH-CONNECT DEVICE HOLDER

1693

-CONTINUED-

STEP 3 Attach the Tech-Connect Device holder to the large chrome Accessory Mount Plate (Premium-XL Chrome Mount) by inserting one of the included #8 Phillips head screws and washers through a slot on each side of the Plate and threading them into the back of the Tech-Connect Device Holder. PIC 2 and PIC 3 Tighten securely.

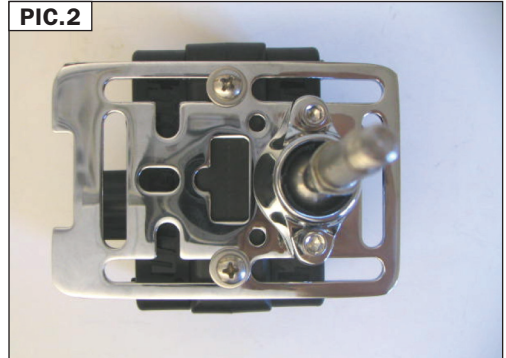

STEP 4 Attach the Tech-Connect Device Holder to the black plastic Accessory Mount Plate (Standard or Premium Chrome) by inserting one of the included #8 Phillips head screws and washers through the top and bottom slots on the Plate and threading them into the back of the Tech-Connect Device Holder. PIC 4 Tighten securely.

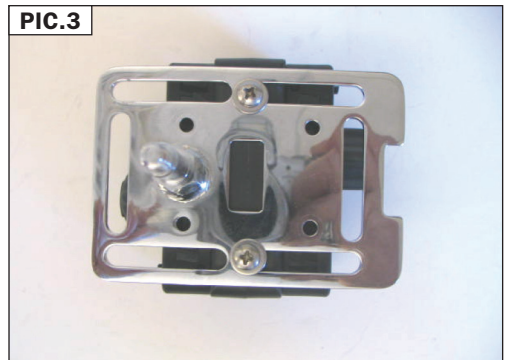

WARNING TO PREVENT POSSIBLE LOSS OF CONTROL, WHICH COULD RESULT IN SERIOUS INJURY OR DEATH, WE DO NOT RECOMMEND REMOVING, REPLACING OR OPERATING THE DEVICE IN THE TECH-CONNECT WHILE RIDING THE MOTORCYCLE .

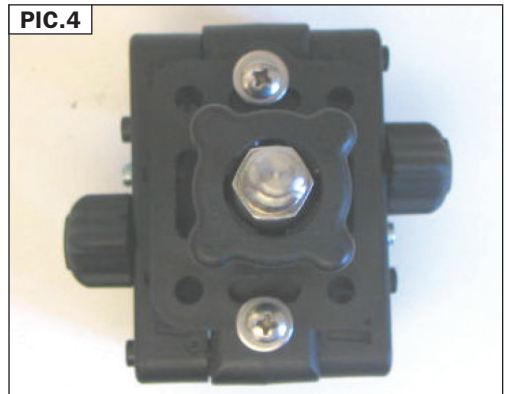

NOTICE IT IS THE INSTALLER'S RESPONSIBILITY TO ENSURE THAT ALL OF THE FASTENERS (INCLUDING PRE-ASSEMBLED) ARE TIGHTENED BEFORE OPERATION OF THE MOTORCYCLE. KURYAKYN WILL NOT ISSUE A WARRANTY ON COMPONENTS LOST DUE TO IMPROPER INSTALLATION. PERIODIC MAINTENANCE MAY BE REQUIRED.

KURYAKYN.COM

866 277 9598 | INFO@KURYAKYN.COM
454 COUNTY ROAD VV SOMERSET, WI 54025



INSTALLATION INSTRUCTIONS

TECH-CONNECT DEVICE HOLDER

1693

-CONTINUED-

USING THE TECH-CONNECT HOLDER

STEP 1 Open the Tech-Connect Holder so the sides are separated from the center section. Peel the narrow pieces of foam off the backing paper, center them in the inset portion of the sides and apply them to the sides of the holder. Peel the wide piece of foam from the backing paper, center it in the inset portion in the center and apply it to the center of the holder. PIC 5 and PIC 6

STEP 2 To adjust the opening in the Tech-Connect larger, turn the knobs on the outside of the Tech-Connect (PIC 5) counter clockwise until your device will fit in between the arms. Turn the knobs clockwise to close the arms around the device. There is a locking detent under the knobs to hold them in place once they come in contact with the device. DO NOT over tighten the knobs. Tightening them too tight will not allow you to loosen them with your fingers. Periodically check the tightness of the mobile device in the Tech-Connect.

NOTE: For best results keep "L" shaped foot portion of the Tech-Connect Holder on the bottom of the device. Keep the device holding support arms centered on the mounting plate.

WARNING

ENSURE THAT THERE IS CLEARANCE AT ALL POINTS WHEN THE HANDLEBARS ARE TURNED. INSUFFICIENT CLEARANCE MAY CAUSE DAMAGE TO THE MOTORCYCLE OR CAN CAUSE LOSS OF CONTROL THAT COULD RESULT IN SEVERE INJURY OR DEATH.

DO NOT ATTEMPT TO OPERATE OR REMOVE THE MOBILE DEVICE FROM THE HOLDER WHILE OPERATING THE MOTORCYCLE.

NOTICE

ENSURE THAT THE MOBILE DEVICE IS SECURE IN THE TECH-CONNECT HOLDER. KURYAKYN IS NOT RESPONSIBLE FOR ANY DEVICE THAT IS STOLEN OR DAMAGED FROM USE IN THIS HOLDER OR FROM THE HOLDER NOT BEING PROPERLY SECURED TO THE MOTORCYCLE. IT IS THE INSTALLER'S RESPONSIBILITY TO ENSURE THAT ALL OF THE FASTENERS (INCLUDING PREASSEMBLED) ARE TIGHTENED BEFORE OPERATION OF THE MOTORCYCLE. KURYAKYN WILL NOT ISSUE A WARRANTY ON COMPONENTS LOST DUE TO IMPROPER INSTALLATION. PERIODIC MAINTENANCE MAY BE REQUIRED.

MOTORCYCLING CAN BE DONE IN A HARSH ENVIRONMENT. MAKE SURE YOUR MOBILE DEVICE IS APPROPRIATE FOR THIS APPLICATION.

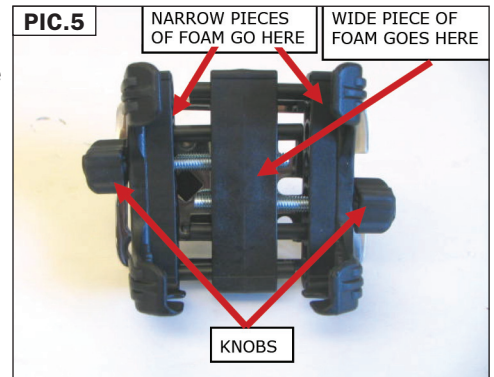

KURYAKYN.COM

866 277 9598 | INFO@KURYAKYN.COM
454 COUNTY ROAD VV SOMERSET, WI 54025



INSTALLATION INSTRUCTIONS

TECH-CONNECT DEVICE HOLDER

1693

-CONTINUED-

LIMITED WARRANTY

Kuryakyn warrants that any Kuryakyn products sold hereunder, shall be free of defects in materials & workmanship for a period of one (1) year from the date of purchase by the consumer excepting the following provisions:

1. Kuryakyn shall have no obligation in the event the customer is unable to provide a receipt showing the date the customer purchased the product(s).
2. The product must be properly installed, maintained & operated under normal conditions.
3. Kuryakyn shall not be liable for any consequential & incidental damages, including labor & paint, resulting from failure of a Kuryakyn product, failure to deliver, delay in delivery, delivery in nonconforming condition, or for any breach of contract or duty between Kuryakyn & a customer.
4. Kuryakyn products are often intended for use in specific applications. Kuryakyn makes no warranty if a Kuryakyn product is used in applications other than intended.
5. Kuryakyn electrical products are warranted for one (1) year from the date of purchase by the consumer. L.E.D.'s contained in components of Kuryakyn products will be warranted for defects in materials & workmanship for 3 years from the date of purchase whereas all other components shall be warranted for one (1) year.
6. All warranty claims must be directed to the place of purchase. Merchandise sold through internet auction sites or any other unauthorized reseller shall not carry a Kuryakyn warranty. If unsure, please contact the place of purchase to verify they are an authorized Kuryakyn reseller.

RETURN POLICY

Merchandise determined to be defective may be returned up to one year from the date of purchase. Returns must be processed through original seller. Returned merchandise for any other reason other than warranty claims must be in like new condition & subject to a 20% restocking fee. All returns are subject to inspection for determination of full or partial credit. Any returned part that shows evidence of being used or installed contrary to manufacturer's instructions, &/or subjected to improper handling, packaging or return shipping by the customer, will not be eligible for exchange, refund or warranty consideration. All returned electrical items will be inspected & tested. If electrical item is deemed functional, no credit will be issued & item will be returned. All sales are final on discontinued or closeout merchandise.

©2015 KURYAKYN HOLDINGS, LLC ALL RIGHTS RESERVED

KURYAKYN, KURYAKYN K logo and the marks appearing on this instruction sheet are registered and common law trademarks of Kuryakyn Holdings except noted third-party trademarks. A full listing of trademarks and trademark registrations owned by Kuryakyn Holdings can be found at www.kuryakyn.com/legal-notice.

Emissions Notice: The California Air Resources Board (CARB) does not permit the use of aftermarket emission-related parts(s) that alter the performance of OEM emission-related devices unless CARB has issued an Executive Order, other than on racing vehicles on closed courses. Check your local laws and manufacturer's information.

Listed Manufacturers and product model names are for reference only. All product and company names are trademarks or registered trademarks of their respective holders. Use of them does not imply any affiliation with or endorsement by them. All specifications are subject to change without notice.

For additional information on third-party product and company names, please consult our Web page at www.kuryakyn.com/legal-notice

KURYAKYN.COM

866 277 9598 | INFO@KURYAKYN.COM
454 COUNTY ROAD VV SOMERSET, WI 54025

